

Stepping Motors

M49SP-1

OUTLINE

"M49SP-1" has acquired the highest output torque among the outer diameter 49mm model series—holding torque : 181.3mN·m, pull-out torque : 62.7mN·m/150pps, and pull-in torque : 60.8mN·m/150pps (12V DC).

With superior running noiselessness and other features, this model motor is the most suited to future, compact electronic equipment.



FEATURES

1. High output torque.
2. Superior running quietness and stability.
3. Step angle : 7.5°.
4. Excellent responsiveness acquired.

USES

Printers, multifunction machines, copy machines, FAX, and such.

SPECIFICATIONS

| Items | M49SP-1 | |
|--------------------------|---|--------------------|
| | DC 12V | DC 24V |
| Rated Voltage | DC 12V | DC 24V |
| Working Voltage | DC 10.8~13.2V | DC 21.6~26.4V |
| Rated Current/Phase | 431mA | 216mA |
| No. of Phase | 4 Phase | 4 Phase |
| Coil DC Resistance | 30Ω/phase±7% | 120Ω/phase±7% |
| Step Angle | 7.5°/step | 7.5°/step |
| Excitation Method | 2-2 Phase excitation (Unipolar driving) | |
| Insulation Class | Class E insulation | Class E insulation |
| Holding Torque | 181.3mN·m | 176.4mN·m |
| Pull-out Torque | 62.7mN·m/150pps | 60.8mN·m/150pps |
| Pull-in Torque | 60.8mN·m/150pps | 58.8mN·m/150pps |
| Max. Pull-out Pulse Rate | 290pps | 290pps |
| Max. Pull-in Pulse Rate | 280pps | 280pps |

CHARACTERISTICS

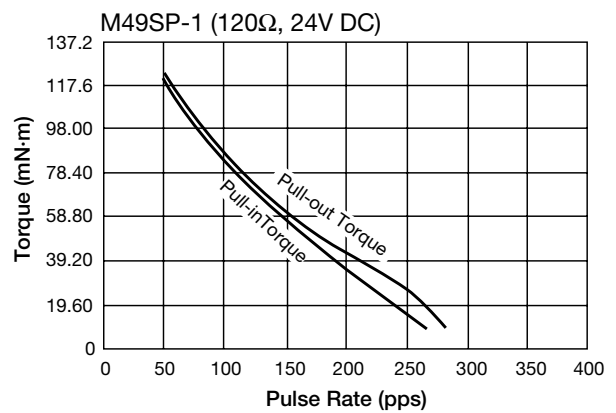
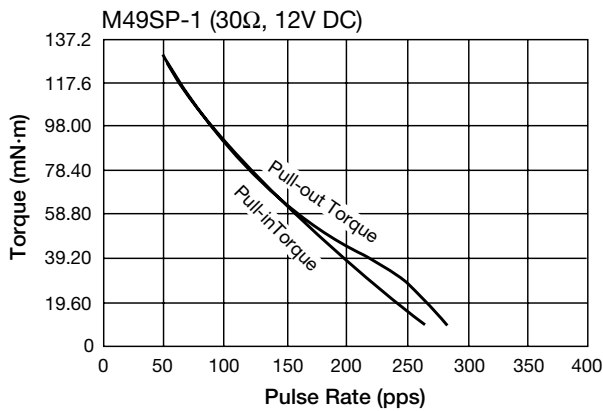

DIMENSIONS

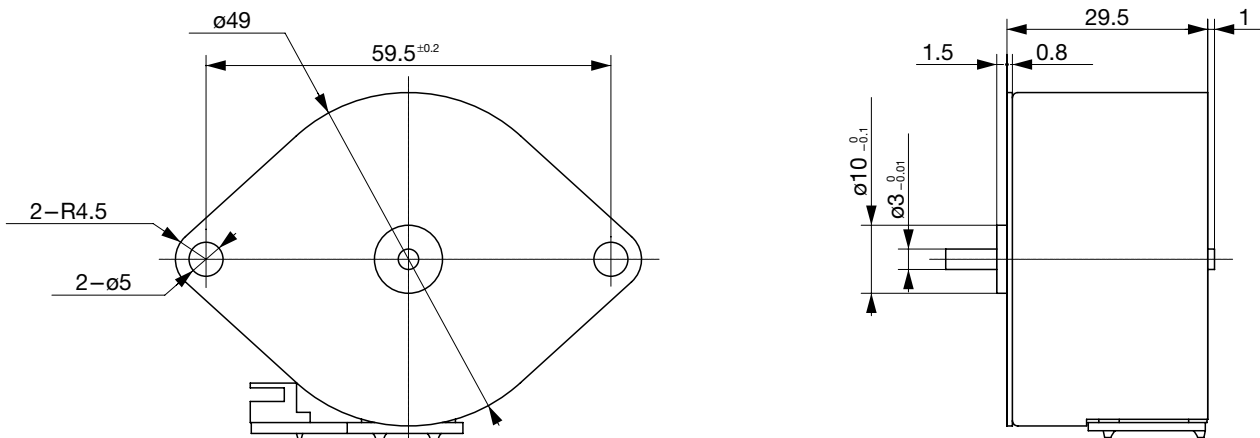

Unit : mm, General tolerance : ±0.5