



# THOMSON

## AUDIO

### Brandt

### FERGUSON

### SABA

### TELEFUNKEN

### THOMSON

**PARTS LIST**  
**LISTE PIECES DETACHEES**  
**ERSATZTEILLISTE**  
**LISTA PARTI DI RICAMBIO**  
**LISTA DE PIEZAS DE REPUESTO**



**THOMSON**  
**DPL570HT**  
**Chassis PAV5108**

#### MODULES

MAIN	MAIN	R 55256740
AMPL	AMPLI	R 55256780
DSP	DSP	R 55256810
KDB	DISPLAY/CONTROL	R 55256790
POWE	POWER	R 55256800
RFFI	TUNER	R 55274940



IC003,005	74VHC245MTR FLAT	55257920
IC006	CS5333-KZ FLAT	55162980
IC007	CS4334-KS FLAT	45055370
IC008,009,010,011	BA4558F FLAT	20976940
IC018	CS4360-KZ FLAT	55162990
IC019,020	74VHC574MTR FLAT	55257910
IC022	AT27LV010A-90JC FLAT	35129180
IC023	CS493263-CL FLAT	55125380
IC024	CS8415A-CS FLAT	55125410
IC200	LC78211	35093840
IC202,301,302,401,402,403	KIA4558F	20920060
IC203	NJM2296 FLAT	35128070
IC303	KIA7815PI	35128320
IC304	KIA7915PI	35093430
IC305	KIA7805API	55123960
IC306,307	LM317T	△ 46043600
IC400	M62446AFP FLAT	55435360
IC404	BH3544F FLAT	55081330
IC701	UPD78P0208GF FLAT	55152930
IC702	M24C02WMN6 FLAT	35096320
IR701	GP1U287R	20852030



ICP01	PSR-5	55173540
Q001,002	KRC107S SMD	55051240
Q003,004,309,702,703,704	KTC3875GR SMD	20779850
Q081,087	DTC323TK SMD	35095360
Q082,086	DTA114YKA SMD	35095350

Q083,084,085	2SK117Y	35095520
Q101,701	KTC3203Y/KTC2120Y	20538220
Q300,605,607,615,620,622,630,635,637,645,650,652,660,665,667,675,691,692,699	KTC3200BL	20556600
Q301,302,303,304,604,619,634,649,664,680	2SA1266Y	20508210
Q305,306	KTC3198GR	20508070
Q308	KTA1298Y SMD	55050930
Q404,405,406,407,408,409,416,417	KTD1302	35093290
Q411,412,413,414,415	DTC114YKA SMD	35095340
Q425,426,427,428	DTA114YSA	10212520
Q601,602,603,606,616,617,618,621,631,632,633,636,646,647,648,651,661,662,663,666,677,678,679,693	KTA1268GR	35093320
Q608,623,638,653,668,695	2SC4137	35108350
Q609,624,639,654,669,694	KTA1024	35108380
Q610,625,640,655,670,696	KTC3206Y	35096960
Q613,626,628,658,673	2SD2589	55199190
Q614,627,629,659,674	2SB1659	55201950
Q643	2SD2493	35108360
Q644	2SB1624	35108370
Q676A,676B	DTC114YSA	35108390



D001	1SS355 SMD	20726770
D101,102,103,104,107,108,109,110,112,113,300,301,302,303,304,716	1N4002	11070780
D105	1N4751A	20743260
D111,400,401	1N5235B	20526990
D112	G5SBA60	55192330
D200,406,407,408,409,410,411,412,413,414,415,416,417,421,422,423,424,481,601,602,603,604,605,606,607,608,609,610,611,612,613,704,705,706,708,709,710	1N4148	44009209
D306,402	BZX55B5V1/ZPD5V1 2%	44035702
D308	BZX85C12	70437720
D701,711	1N5232B 5.6V	20414280
D702	LTL-1CHE3 LED	35095420



X1	12M288HZ	35128290
Y701	5MHZ	55093460



L101		70182000
------	--	----------



**R : RECYCLED PART**  
**: PIECE RECYCLEE**  
**: AUSTAUSCHTEILE**  
**: RICAMBIO RICICLATO**  
**: MODULO REPROCESADO**

For any requests, please contact THOMSON multimedia after sales service area  
 Pour toutes précisions, contactez votre service après vente local THOMSON multimedia  
 Für weitere Auskünfte, wenden Sie sich bitte an die THOMSON multimedia Kundendienst  
 Per precisazioni, contattare l'assistenza tecnica THOMSON multimedia  
 Para cualquier pregunta, por favor contactar con el responsable de zona del servicio postventa de THOMSON multimedia

**VERSION 1 04 / 2003 35716300**  
**VERSION 2 00 / 0000**

1/4

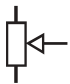
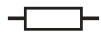
No copying, translation, modification on other use authorized. All rights reserved worldwide. • Tous droits de reproduction, de traduction, d'adaptation et d'exécution réservés pour tous les pays. • Sämtliche Urheberrechte an diesen Texten und Zeichnungen stehen uns zu. Nachdrucke, Vervielfältigungen - auch auszugsweise - nur mit unserer vorherigen Zustimmung zulässig. Alle Rechte vorbehalten. • I diritti di riproduzione, di traduzione, e esecuzione sono riservati per tutti i paesi. • Derechos de reproducción, de traducción, de adaptación y de ejecución reservados para todos los países.

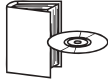
	EN701	55407950	
	MR601,602,603, 0R39 OHM 5W	35108400	
	604,605,606		
	R322,323 0R1 OHM 5% 5W	20696190	
	C101,102 4N7F 20% 250V	△ 20677520	
	C120,121 6800UF 20% 50V	△ 20588260	
	T101	△ 55249580	
	T102 (STAND-BY)	△ 55269220	
<b>OTHER PARTS</b> <b>AUTRES PIECES</b> <b>SONSTIGE TEILE</b> <b>ALTRE PARTI</b> <b>OTRAS PIEZAS</b>			
DP01	DISPLAY LCD AFFICHEUR LCD LCD-ANZEIGE VISUALIZZATORE LCD VISUALIZADOR LCD	55198380	
F101	2A5T 250V TIME-LAG FUSE △ 10246750 2A5T 250V FUSIBLE TEMPORISE 2A5T 250V SICHERUNG 2A5T 250V FUSIBILE TEMPORIZZATO 2A5T 250V FUSIBLE TEMPORIZADO		
F102	500MAT TIME-LAG FUSE △ 35117150 500MAT FUSIBLE TEMPORISE 500MAT SICHERUNG 500MAT FUSIBILE TEMPORIZZATO 500MAT FUSIBLE TEMPORIZADO		
F103,104	5AT TIME-LAG FUSE △ 35043570 5AT FUSIBLE TEMPORISE 5AT SICHERUNG 5AT FUSIBILE TEMPORIZZATO 5AT FUSIBLE TEMPORIZADO		
F105,106	2AT 250V TIME-LAG FUSE △ 48029300 2AT 250V FUSIBLE TEMPORISE 2AT 250V SICHERUNG 2AT 250V FUSIBILE TEMPORIZZATO 2AT 250V FUSIBLE TEMPORIZADO		
HD601	JACK SOCKET 35097390 PRISE JACK BUCHSE PRESA JACK TOMA JACK		
JA300	CINCH SOCKET 3P 35130490 PRISE CINCH 3P CHINCH-BUCHSE 3P PRESA CINCH 3P TOMA CINCH 3P		
JK104	LOUDSPEAKER SOCKET X8 PRISE HAUT PARLEUR X8 LAUTSPRECHERBUCHSE X8 PRESA ALTOPARLANTE X8 TOMA ALTAVOZ X8	55158030	
JK105	LOUDSPEAKER SOCKET X4 PRISE HAUT PARLEUR X4 LAUTSPRECHERBUCHSE X4 PRESA ALTOPARLANTE X4 TOMA ALTAVOZ X4	55158020	
JK106	CINCH SOCKET X9 PRISE CINCH X9 CHINCH-BUCHSE X9 PRESA CINCH X9 TOMA CINCH X9	55278730	
JK107,108	CINCH SOCKET 3P PRISE CINCH 3P CHINCH-BUCHSE 3P PRESA CINCH 3P TOMA CINCH 3P	35128240	
JK109	CINCH SOCKET 6P PRISE CINCH 6P CHINCH-BUCHSE 6P PRESA CINCH 6P TOMA CINCH 6P	35128230	
JK111	CINCH SOCKET X1 PRISE CINCH X1 CHINCH-BUCHSE X1 PRESA CINCH X1 TOMA CINCH X1	55288330	
OP1	OPTICAL SOCKET PRISE OPTIQUE OPTICAL-BUCHSE PRESA OTTICA TOMA OPTICO	35109050	
RCA1	CINCH SOCKET X1 PRISE CINCH X1 CHINCH-BUCHSE X1 PRESA CINCH X1 TOMA CINCH X1	55188070	
RY101	SDT-S-112LMR RELAY 12V △ 35095470 SDT-S-112LMR RELAIS 12V SDT-S-112LMR RELAIS 12V SDT-S-112LMR RELEE 12V SDT-S-112LMR RELEE 12V		
SW701,702,703,704,705,706,707,708,709,710,711,712,713,714,715,716,717,718,719	MICROSWITCH MICRO CONTACTEUR MIKROSCHALTER MICROINTERRUTTORE MICROCONTACTOR	20404680	
<b>EQUIPMENT/PRESENTATION</b> <b>EQUIPEMENT/PRESENTATION</b> <b>AUSSTATTUNG/GEHAEUSE</b> <b>PARTI VARIE</b> <b>EQUIPO/PRESENTACION</b>			
RC560	REMOTE CONTROL TELECOMMANDE FERNBEDIENUNG TELECOMANDO TELEMANDO	21178860	
DPL570HT	LOUDSPEAKER BOX ASSY X6 ENCEINTES ACOUSTIQUES X6 LAUTSPRECHERBOX K.P.L X6 CASSA ACUSTICA COMPLETO X6 CAJA ACUSTICA EQUIPADO X6	55029560	
CENTRAL	LOUDSPEAKER BOX ENCEINTE ACOUSTIQUE CENTRALE CENTRAL LAUTSPRECHERBOX CASSA ACUSTICA PRINCIPALE CENTRALE CAJA ACUSTICA PRINCIPAL CENTRAL	35716410	
SURROUND LOUDSPEAKER BOX RIGHT OR LEFT 35716400 ENCEINTE ACOUS SURROUND DROITE OU GAUCHE SURROUND LAUTSPRECHERBOX RECH. OD. LINKS CASSA ACUSTICA SURR. DESTRA O SINISTRA CAJA ACUSTICA SURR. DERECHA O IZQUIEDA  MAIN LOUDSPEAKER BOX RIGHT OR LEFT 35716390 ENCEINTE ACOUS.PRINCIP. DROITE OU GAUCHE MAIN LAUTSPRECHERBOX RECHTS ODER LINKS CASSA ACUSTIC.PRINCIP. DESTRA O SINISTRA CAJA ACUSTIC.PRINCIP.DERECHA O IZQUIERDA  LOUDSPEAKER BOX SUBWOOFER 35716420 ENCEINTE ACOUSTIQUE SUBWOOFER LAUTSPRECHERBOX SUBWOOFER CASSA ACUSTICA SUBWOOFER CAJA ACUSTICA SUBWOOFER  FOLDING BOX 55716910 EMBALLAGE CARTON KARTON IMBALLGGIO CARTONE EMBALAJE CARTON  POWER SUPPLY LEAD △ 35710770 CORDON D'ALIMENTATION NETZKABEL CAVO DI ALIMENTAZIONE CABLE DE ALIMENTACION  FM ANTENNA 35103510 ANTENNE FM FM ANTENNE ANTENNA FM ANTENA FM  CONNECTION LEAD 1+1 CINCH 35093990 CORDON DE LIAISON 1+1 CINCH ANSCHLUSSKABEL 1+1 CINCH CAVO DI ALLACCIAMENTO 1+1 CINCH CAVO DI ALLACCIAMENTO 1+1 CINCH  CONNECTION LEAD 2+2 CINCH (RED-WHITE) 25347770 CORDON DE LIAISON 2+2 CINCH(ROUGE-BLANC) ANSCHLUSSKABEL 2+2 CINCH (ROT-WEISS) CAVO DI ALLACCIAM.2+2 CINCH(ROSSA-BIANC) CABLE DE ENLACE 2+2 CINCH (ROJA-BIANCO)  AM ANTENNA(FRAME) 20690640 ANTENNE AM(CADRE) AM ANTENNE(FRAME) ANTENNA AM(FRAME) ANTENA AM(FRAME)  AM ANTENNA HOLDER 20690520 SUPPORT ANTENNE AM AM ANTENNENHALTER SUPPORTO ANTENNA AM SOPORTE ANTENA AM			
	DPL570HT UM TH	55716930	
	DPL570HT NU TH DPL570HT BA TH DPL570HT IU TH DPL570HT IU TH		
	DPL570HT PARTS LIST 35716300 DPL570HT LISTE DE PIECES DETACHEES DPL570HT ERSATZTEILLISTE DPL570HT LISTA PARTI DI RICAMBIO DPL570HT LISTA DE PIEZAS DE REPUESTO PAV5008/5009 TH SERVICE MANUAL 35653950 PAV5008/5009 TH DOCUMENTATION TECHNIQUE PAV5008/5009 TH TECHNISCHE DOKUMENTATION PAV5008/5009 TH DOCUMENTAZIONE TECNICA PAV5008/5009 TH DOCUMENTACION TECNICA		

**CHASSIS AND PRESENTATION**  
**CHASSIS ET PRESENTATION**  
**CHASSIS UND GEHAEUSETHEILE**  
**TELAIO E DI PRESENTAZIONE**  
**CHASIS Y PRESENTACION**

AMPL	AMPL BOARD	55256780
	AMPLI PLATINE	
	AMPLI PLATTE	
	AMPLI PIASTRA	
	AMPLI PLATINA	
DSP	DSP BOARD	55256810
	DSP PLATINE	
	DSP PLATTE	
	DSP PIASTRA	
	DSP PLATINA	
KDB	DISPLAY/CONTROL BOARD	55256790
	DISPLAY/CONTROL PLATINE	
	DISPLAY/CONTROL PLATTE	
	DISPLAY/CONTROL PIASTRA	
	DISPLAY/CONTROL PLATINA	
MAIN	MAIN BOARD	55256740
	MAIN PLATINE	
	MAIN PLATTE	
	MAIN PIASTRA	
	MAIN PLATINA	
POWE	POWER BOARD	55256800
	POWER PLATINE	
	POWER PLATTE	
	POWER PIASTRA	
	POWER PLATINA	
RFFI	TUNER BOARD	55274940
	TUNER PLATINE	
	TUNER PLATTE	
	TUNER PIASTRA	
	TUNER PLATINA	
020	FRONT PANEL	55029630
	FACADE	
	FRONTPLATTE	
	PANNELLO FRONTALE	
	PANEL FRONTAL	
030	LOWER FRONT PANEL	55272130
	PANNEAU FRONTAL INFERIEUR	
	UNTER-FRONTPLATTE	
	PANNELLO FRONTALE INFERIORE	
	PANEL FRONTAL INFERIOR	
040	LOWER SIDE PANEL RIGHT	55272150
	PANNEAU INFERIEUR LATERAL DROIT	
	SEITENTEIL RECHTS	
	PANNELLO LATERALE INFERIORE DESTRO	
	PANEL LATERAL INFERIOR DERECHO	
050	LOWER SIDE PANEL LEFT	55272170
	PANNEAU INFERIEUR LATERAL GAUCHE	
	SEITENTEIL LINKS	
	PANNELLO LATERALE INFERIORE SINISTRO	
	PANEL LATERAL INFERIOR IZQUIERDO	
060	BUTTON COVER PANEL	55272230
	ENJOLIVEUR SUPERIEUR BOUTON	
	TASTE ZIERRAHMEN OBEN	
	FINIZIONE SUPERIORE TASTO	
	EMBELLECEDOR SUPERIOR TECLA	
070	DISPLAY WINDOW	55272190
	GLACE AFFICHEUR	
	ANZEIGEFENSTER	
	VETRO DEL VISUALIZZATORE	
	CRISTAL DEL VISUALIZADOR	
080	VOLUME KNOB	55272210
	BOUTON VOLUME	
	LAUTSTAERKEKNOPF	
	ROTELLA DI PLASTICA VOLUME	
	RUEDA PLASTICA MANDO	
090	SET BUTTON	55257330
	TOUCHE SET	
	SET TASTE	
	TASTO SET	
	TECLA SET	

100	ON/OFF BUTTON TOUCHE MARCHE/ARRET EIN-AUS TASTE TASTO ACCESO/SPENTO TECLA MARCHA/PARADA	55284630
105	SOURCE UP BUTTON TOUCHE SOURCE UP TASTE SOURCE UP TASTO SOURCE UP TECLA SOURCE UP	55281460
110	MUTE/BASS/LEVEL BUTTON TOUCHE MUTE/BASS/LEVEL MUTE/BASS/LEVEL TASTE TASTO MUTE/BASS/LEVEL TECLA MUTE/BASS/LEVEL	55257370
115	SOURCE DOWN BUTTON TOUCHE SOURCE DOWN TASTE SOURCE DOWN TASTO SOURCE DOWN TECLA SOURCE DOWN	55281470
130	SURROUND MODE BUTTON TOUCHE SURROUND MODE SURROUND MODE TASTE TASTO SURROUND MODE TECLA SURROUND MODE	55257390
140	DSP MODE BUTTON TOUCHE DSP MODE DSP MODE TASTE TASTO DSP MODE TECLA DSP MODE	55257410
145	BUTTON STRIP 10T FUNCTIONS BARRETTE 10 TOUCHES FONCTION TASTENLEISTE FUNKTIONEN 10T PIATTINA 10 TASTI FUNZIONI PLACA DE 10 TECLAS FUNCIONES	55280330
200	UPPER CASE ASSY COFFRET SUPERIEUR GEHAEUSE OBEN CASSA SUPERIORE CAJA SUPERIOR	55380100

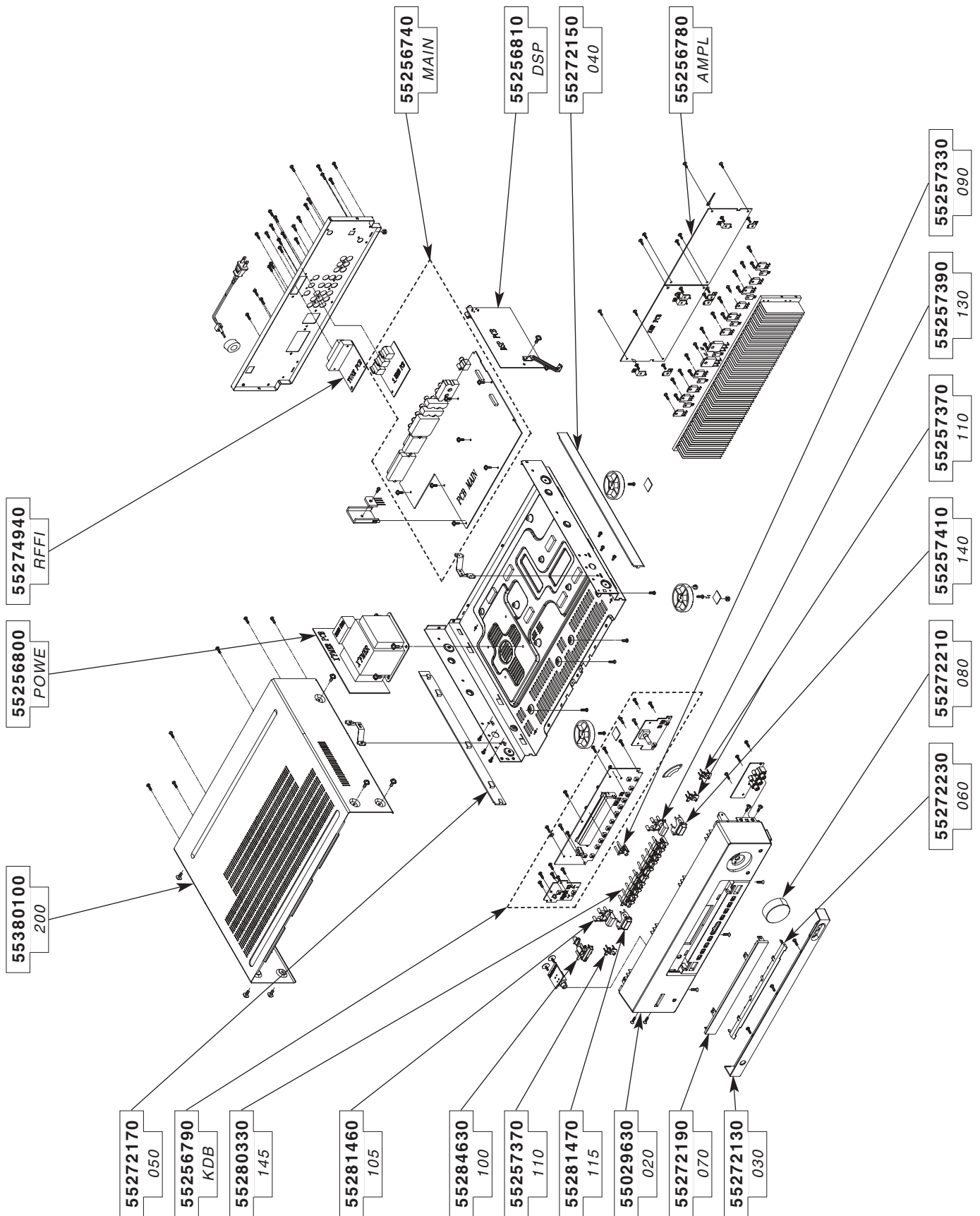

## CHASSIS AND PRESENTATION / CHASSIS ET PRESENTATION / CHASSIS UND GEHAEUSETEILE / TELAIO E DI PRESENTAZIONE / CHASIS Y PRESENTACION

DPL570HT

4/4

The description and characteristics given here are of informative significance only, and non committal. To keep up the high quality of our products, we reserve the right to make any changes or improvement without previous notice. • Les descriptions et caractéristiques figurant sur ce document sont données à titre d'information et non d'engagement. En effet, soucieux de la qualité de nos produits, nous nous réservons le droit d'effectuer, sans préavis, toute modification ou amélioration. • Die Beschreibungen und Daten in dieser Anleitung dienen nur zur Information und sind nicht bindend. Um die Qualität unserer Produkte ständig zu verbessern, behalten wir uns das Recht auf Änderungen vor. • Le descrizioni e le caratteristiche date su questo documento sono fornite a semplice titolo informativo e senza impegno. Ci riserviamo il diritto di eseguire, senza preavviso, qualsiasi modifica o miglioramento. • Las descripciones y características que figuran en este documento se dan a título de información y no de compromiso. En efecto, en bien de la calidad de nuestros productos, nos reservamos el derecho de efectuar, sin previo aviso, cualquier modificación o mejora.